

Q² MOHS

DIRECTIONS:

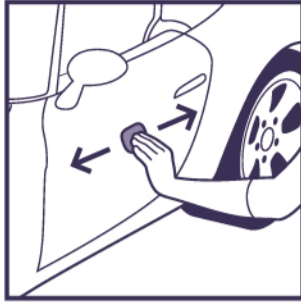

Wash the car with a strong degreasing agent.



On used cars, claying and use of Q²MIRON is recommended.

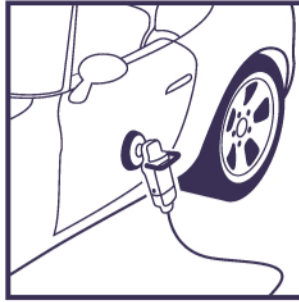

If a car is scratched, make sure paint correction is performed first by a professional detailing shop.

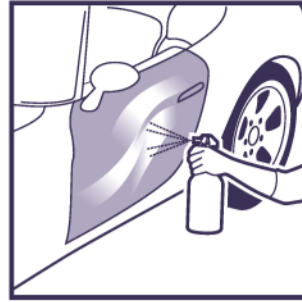

Ensure the surface is oil free and completely dry.
Use Q²MPREP before applying the coating (isopropyl alcohol does not fully degrease the surface).

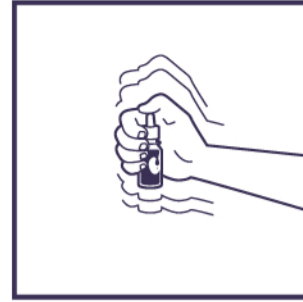

Shake the Q²MOHS bottle before use.



Apply a thick layer of Q²MOHS in a criss cross motion. Pay attention to the leveling of the coating. If needed, make a second criss cross pass to achieve a perfectly even layer.

GYEON[®]

quartz cloth

MANUAL INSTRUCTIONS



If the coating is being applied in hot conditions, split larger panels (roof, bonnet, SUV doors) in parts.

PRECAUTIONS:

- Skin protection recommended.
- Work in a well-ventilated area.
- Store in a dry, cool place.
- Keep out of reach of children.
- Avoid applying in direct sunlight.



Start wiping off before product completely dries out (test on a half of the panel before full coating). Wipe off carefully, do not allow any streaks or smudges to be left. Please note that the drying time may vary from 30 seconds to even 5 minutes depending on country's climate (ask your reseller for advice).

Apply at least one more coat after a minimum of 1 hour. Each additional coat increases thickness and hardness. Apply a maximum of 3 layers of Q²MOHS.

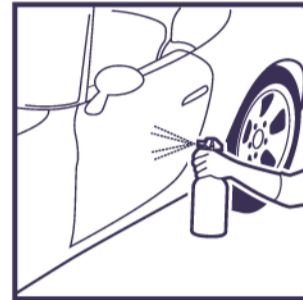

Let it dry for 12-24 hours and wipe it off with Q²M CURE. Apply Q²M CURE with a soft MF. Spray Q²M CURE onto the MF and not directly on the paint/coating. DO not allow any streaks to be left. Work in sections, panel by panel.



In hot, rainy climates, we recommend to top up the bonnet, roof and bootlid off with a HD natural wax at least after 12-24 hours to protect the coating against potential water spots while curing completely for 2-3 weeks.

The coating is fully dry after 24hours. Only after that time can the car be driven.

Drying process can be shortened if the coating is heated with infrared lamps 10 minutes per panel.

Do not wash the car with any detergents within the first 7 days.

Q² PRIME

DIRECTIONS:



Wash the car with a strong degreasing agent.

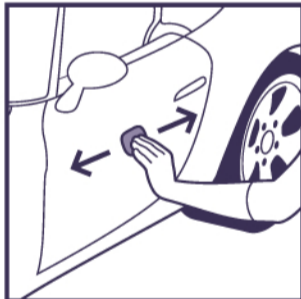

On used cars, claying and use of Q²MIRON is recommended.

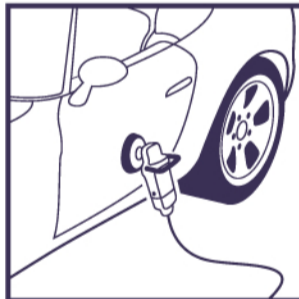

If a car is scratched, make sure paint correction is performed first by a professional detailing shop.

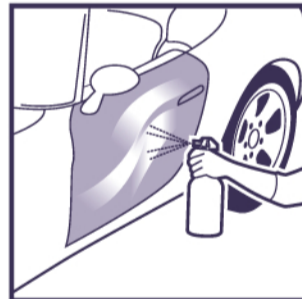

Ensure the surface is oil free and completely dry.
Use Q²MPREP before applying the coating (isopropyl alcohol does not fully degrease the surface).

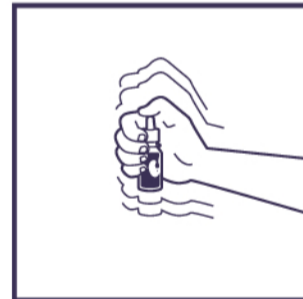

Shake the Q²PRIME bottle before use.



Apply a thick layer of Q²PRIME in a criss cross motion. Pay attention to the leveling of the coating. If needed, make a second criss cross pass to achieve a perfectly even layer.



Split larger panels (roof, bonnet, SUV doors) in sections, apply carefully.



Wipe off immediately (10sec - 2 minutes) after applying to the whole panel/section.

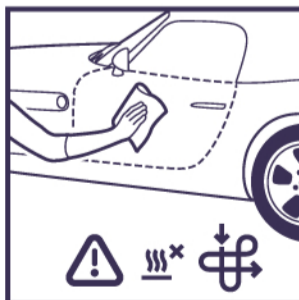

Please note that the drying time may vary from 10 seconds to 2 minutes depending on the country's climate (ask your reseller for advice).
Work panel by panel/section, do not allow to fully dry.

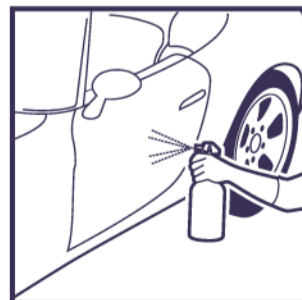

Let it dry for at least 3 hours and wipe off with Q²M CURE. Apply Q²M CURE with a soft MF. Spray Q²M CURE onto the MF and not directly on the paint/coating. DO not allow any streaks to be left. Work in sections, panel by panel.

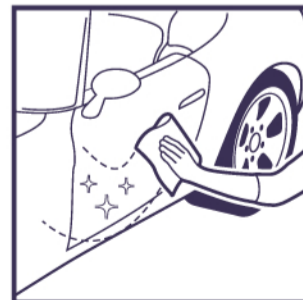

The coat is fully dry after 24 hours. Only after that time can the car be driven.

Drying process can be shortened if the coating is heated with infrared lamps for 10 minutes per panel.

Do not wash the car with any detergents within the first 7 days.

PRECAUTIONS:

- Skin protection recommended.
- Work in a well-ventilated area.
- Store in a dark, dry and cool place.
- Keep out of reach of children.
- Avoid applying in direct sunlight.

Q² RIM

DIRECTIONS:



Wash the rim with a strong degreasing agent.



Always use Q²MIRON while cleaning the surface.
If additional impurities like tar are visible, you can remove them with Q²M CLAY.
Use Q²M PREP before applying the coat (isopropyl alcohol does not fully degrease the surface).

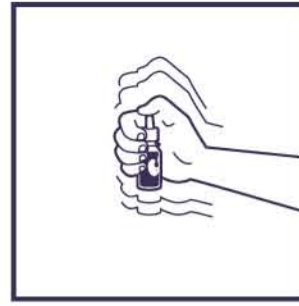

Shake the Q²RIM bottle well before use.

Q² TRIM

DIRECTIONS:



Wash and degrease trim surface with a strong degreasing agent.



Ensure the surface is oil free and completely dry.

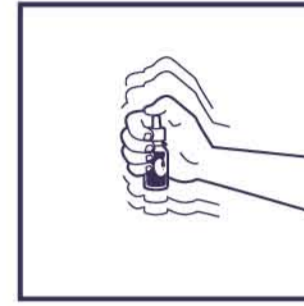

Shake the bottle before use.



Wipe Q²TRIM onto the surface in a crisscross pattern. Ensure a thick layer has built up.



Apply a thick layer with the attached applicator.



Wipe off after 2- 5 minutes depending on climate (ask your reseller for advice).



The coat is fully dry after 24 hours. Only after that time can the car be driven.

Drying process can be shortened if the coating is heated with infrared lamps for 1 hour.

PRECAUTIONS:

- Skin protection recommended.
- Work in a well-ventilated area.
- Store in a dark, dry and cool place.
- Keep out of reach of children.
- Avoid applying in direct sunlight.



PRECAUTIONS:

- Skin and eye protection recommended.
- Use only in a well-ventilated area.
- Keep out of reach of children
- Avoid use in direct sunlight
- Store in a dark, dry and cool place
- Seek medical attention if swallowed or if the user feels unwell.



Wipe off if necessary after 2-5 minutes depending on climate (ask your reseller for advice).

Q² VIEW

Q²CLEANSE:



Clean the window with a high quality glass cleaner.



Use a soft, thick sponge to rub the product in a circular motion into the surface. Work on small areas, ensure precise cleaning.



Wipe the residues of the product with a clean, damp cloth. Wait until the surface dries out completely and apply Q²REPEL.

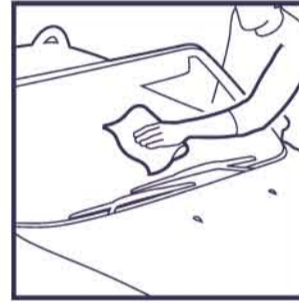

Q²REPEL:



Always use the Q²CLEANSE cleaner to prepare the surface. Apply the product in a circular motion generously in small sections. Use whole 20ml bottle for windshield and 2 side windows.



After few minutes polish light residue with a new, fresh microfiber cloth.

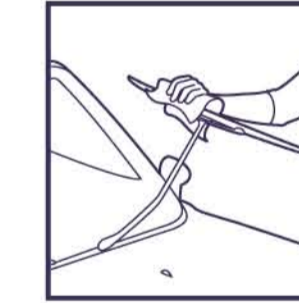

For maximum durability apply a small amount of the product onto your wiper blades or replace them with new ones. Avoid any water for at least a few hours.

PRECAUTIONS:

- Skin protection recommended.
- Work in a well-ventilated area.
- Store in a dark, dry and cool place.
- Keep out of reach of children.
- Avoid applying in direct sunlight.
- Seek medical attention if swallowed or if the user feels unwell.
- Watch out for fire, sparks - don't smoke while using.

Q²M CLAY

DIRECTIONS:



Wash the car before claying.



Form a piece of the clay in the palm of your hand.



Move the clay in straight motion without pressure.



Provide sufficient lube for the clay process (you may use Q²MIRON or diluted Q²M BATHE). Lack of lube may cause light marring.

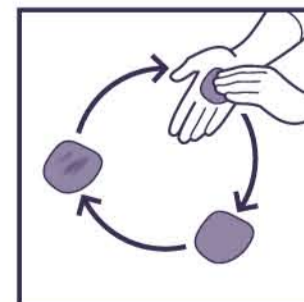

Check the surface of the clay bar - if any contamination are visible knead the bar.

Check the paint's surface for any signs of contamination left. If results are satisfying, move to the next panel/section.



Note, that if your clay bar falls on the ground, it is not reusable!

PRECAUTIONS:

- Keep out of reach of children.
- Always clay in a cool, shady place.